



HiTAC - November 2018

Hi Folks, welcome to the latest issue of the HiTAC.

Comments / opinion and content can be forwarded to Hitac.tac@outlook.com

[View this email in your browser](#)

From the President's Desk



The downstairs upgrade of Taurangi Lodge is now underway. If you are visiting the Lodge remember to obey all signage and follow any instructions from the builder and contractors who may be on site.

Lodge Lockers – as at 27 October, eighteen lockers remain locked, including one of the tall full height ones. The instruction was simple: **empty your locker and leave it unlocked**, and this was to be done by the end of September. Surely not much to ask! For those who have not done this, are we to assume you no longer require a locker?

We've now held the induction for 2018 Open Climb, with the event scheduled to take place on Saturday 16 February. If you were unable to get to the induction but would like to help out on the day, please contact me. We'll be looking for another 20 or so people in addition to those who attended the induction. Also, something that would really assist me – if you usually help but definitely can't make it this year, can you please let me know now.

We have had an awesome response from volunteers who are helping out with the Lodge downstairs upgrade, with many members making valuable contributions in the background. Obviously most of the assistance is required on site, however there are a number of tasks that can be carried out down here in town, so if you can help out in any way at all, please email your contact details to John Thomason who is the Volunteer Co-ordinator for the project: johnthomason242@gmail.com

Club Photo Competition entries have started coming in. Don't forget to send yours in, and please remind others to do the same. See elsewhere in this HiTAC for all the details, closing date is Sunday 18 November.

Elaine Sinton

President

Photo Competition 2018

Our annual photo competition will take place at the December club night.

Entries can be submitted from 1st October. Last day for entries is Sunday 18 November – please don't be late!!!

Please ensure you meet the criteria as outlined below.

Please note instructions for file name and file size, and ensure you follow the example given!

Image Format:

Sized between 1MB and 5 MB

Saved as a JPEG or JPG file

All images must be digital

Submitting Images:

Email to president.tac@outlook.com

Send one photo per email

Entries can be submitted from 1st October

Submit your images by Sunday 18 November

File Name:

Must start with the Category Code, then TAC, followed by the Caption, in that order

e.g. "ABN TAC Frozen Aoraki.jpeg"

The categories for the 2018 competition (to align to FMC) are:

ABOVE BUSHLINE (With no Human Element), Cat Code: ABN

ABOVE BUSHLINE (With a Human Element), Cat Code: ABW

BELOW BUSHLINE (With no Human Element), Cat Code: BBN

BELOW BUSHLINE (With a Human Element), Cat Code: BBW

HISTORIC Code: HIS

NATIVE FLORA & FAUNA, Cat Code: NFF

HUMOUR, Cat Code: HUM

Conditions of Entry:

Adjustments for exposure, white balance, contrast & levels are allowed.

Cropping is allowed

Stitching for panoramic shots is allowed

Removal or insertion of features not in the original image is not allowed.

Entries for the contemporary categories must be taken after 1 Jan 2016. Any photos taken prior to this date will automatically be entered into the historic category.

What defines a "Human Element"?

"The definition of what is a "Human Element" is flexible but the general intention is: Where the photo contains as anything other than as a very minor feature: people, a hut, a track sign/marker, bridge, ice axe and anything else that has been introduced by humans into the environment then we would define that as having "a Human element". But if a photo has what could be called a Human Element but that element is very small, inconsequential and not a feature in the photo then you could count it as "No Human Element".

Multiple entries per category are allowed

The winning entries in each category will be submitted to the national FMC Photo Competition (where eligible).

Photo's taken outside of the New Zealand Exclusive Economic Zone (i.e. North Is, South Is, Stewart, Chatham,

Kermadec, Sub-Antarctic) are permitted for the TAC competition, but are not permitted for the FMC competition

The humour section is TAC only (not FMC)

Entries Close Sunday 18 November

Outdoor Training

OTNZ are providing TAC with a number of courses again this summer. Free for current TAC members.

Details and expressions of interest at the links below.

River safety course - Sunday 18 November, 2018

<https://goo.gl/forms/1VfAnllvEtbAtfGh1>

Navigation course - Saturday 1 December, 2018 (plus a pre-field evening)

<https://goo.gl/forms/uQYRvsWkxSQBkBSV2>

Bushcraft course - Saturday and Sunday 23-24 February, 2019 (plus a pre-field evening)

<https://goo.gl/forms/iI8Sg0TFRa1o5rZH3>

Boots for Sale

!!Boots for sale!!

Lyn White has some leather Asolo boots for sale

Wrong size purchased and they are a tad small [usually wears a size 37-38 shoe]

Have had two trips to the Tahurangi Lodge and gave her blisters both times

Size EU 39 and 1/3, UK 6, Cm 25, USA 7.5

They retail for \$450

Price negotiable - can be test driven if required

Mobile or text 027 444 9800

Home 06 7588080

Old Climbing Gear Looking for a New Home

Collector's Items from the 1960's and 70's

Past member of NZ Alpine Club and also Stratford Mountain Club, Rex Vickers, has recently passed away. Rex had a large collection of old climbing gear dating from the 1960's and 70's which his family would like to donate to anyone who collects such items. Some items have already been distributed to NZAC members, however there are still some old primuses, harnesses which have never been used, and other miscellaneous items. As stated, Rex's family wish these items to be donated to those people who have an interest in historic climbing gear. Please contact me promptly if you would like any of this gear.

Elaine Sinton

Club President

Ph 755-0977

Update on the Tahurangi Lodge

Downstairs Renovation Project

October's fantastic snow dumps unfortunately hindered sufficient access to the translator tower & lodge for us to start the renovation project in early October as planned. However, with the fantastic generosity of some club volunteers, the access track was finally cleared (twice!) and we were able to start work on our exciting renovation project on 22 October. Below is a brief update on progress so far, and to come.

We are employing a builder, electrician, plumber for this project all of whom know the lodge really well. However, to keep costs within budget we are also relying on the extremely kind & generous free time & skills volunteered by many of our club members. From designing & making new cabinetry/furniture, grinding/polishing/coating the floors, digging trenches, hauling materials, cleaning up and, coordinating all manner of things, a **HUGE THANK YOU** goes to all of you who have helped, are helping, and are no doubt yet to help - we couldn't do this project without your hard work & dedication 😊

As at 28 October we have:

- emptied the drying room, polished & coated the floor to a better finish
- removed two internal walls in the downstairs area & partially removed the wall to the old SAR room
- removed all the ceiling tiles in readiness for new wiring
- commenced electrical works
- dug open the existing sewage pipe trenches in readiness for new bathroom drainage

November will see the new bathroom being installed, the current (old) bathroom & associated walls being entirely removed and, the upgrade to the overall downstairs area taking shape.



Club volunteers digging the access track



John & electric wheel barrow!



Floor grinding - a dusty job.



Charlie enjoying the floor grinding PPE...



Entrance walls demolished, SAR wall partially down, ceiling linings gone – it's all happening!

For those of you who didn't empty your lockers and leave them unlocked, the project team will now do this. Club members may use the lodge during the day and/or overnight, however please bear in mind the below constraints.

Non-members will not be granted overnight stays; non-member access during the day will be at the discretion of the project / construction team.

One bunk room and all of the upstairs will remain fully functional. Power & water may be off for very short periods of time.

At least one toilet and one sink is available. The shower may be available.

The dry room is not be available (from now until late-December).

Places to put, hang, store gear & boots is not easily available. A small area will be made available whenever possible, however this will be severely limited. Lockers will also not be available.

The construction team will ensure safe access in/out of the lodge – please follow instructions from them and on any notices/posters for your and their safety at all times.

The project will greatly enhance and extend the life of the club's biggest asset by improving and upgrading the downstairs layout, reducing future maintenance, and providing a new bathroom, more effective drying room, better gear storage and new lockers. Construction is from late October through to late December. The total cost of this major project for the club is \$125,000. Over 60% of the funds have been very kindly granted from TSB (\$50,000), New Zealand Community Trust (\$20,000) and Taranaki Electricity Trust (\$10,000). TAC is contributing the remaining \$45,000. Below is a sketch of the new downstairs layout.

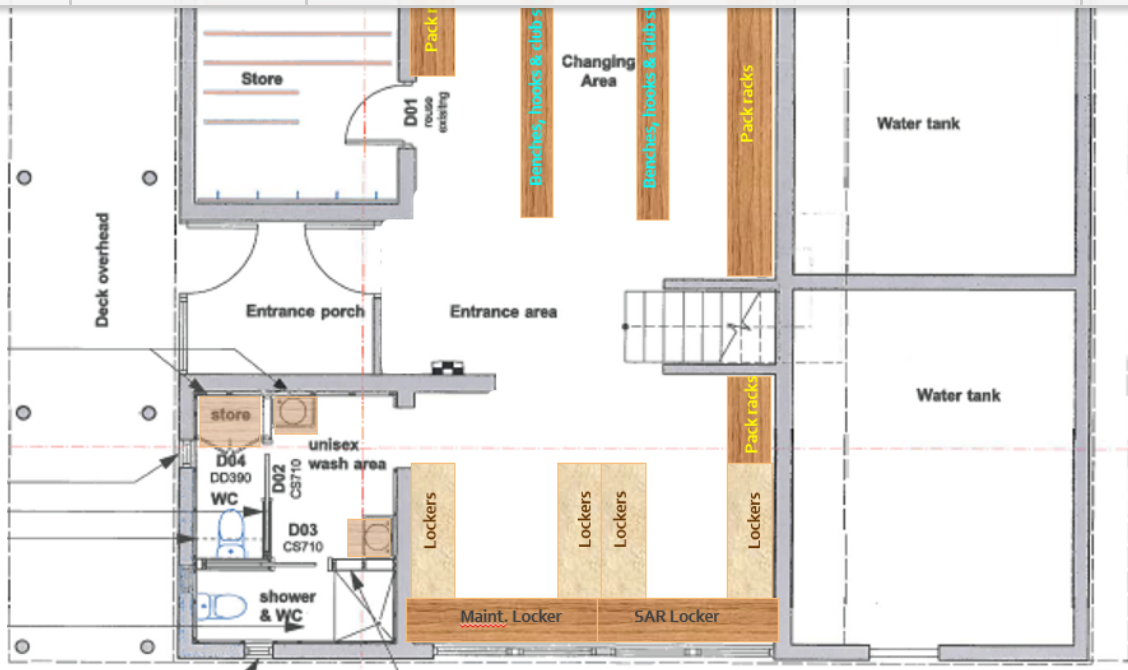

Club Nights

PLEASE NOTE Club nights start at 7:30pm
 First Thursday of each month, at the Foundation for the Blind rooms,
 131 Vivian St, New Plymouth

November 1st John Jordan on his time in Alaska

Come and see what long time TAC alpine instructor John Jordan gets up to.

A six week climbing expedition in late winter to central Alaska - a west - east traverse of Mount McKinley/Denali and ascents of both south and north peaks.

Big mountains, big storms, big avalanches, big glaciers, big crevasses and intense cold.

December 5th Photo Comp & end of year shout.

Club Trips

Our club trips aim to give you the opportunity to practice your alpine & mountaineering skills, get to know Mt Taranaki (and in some cases other awesome NZ mountains), meet other like-minded people and, have some laughs!

It is important to note that our club trips are not instruction courses or formal guided events. Our Trip Leads are experienced club members who kindly volunteer their time to share a route they know reasonably well and meet the above trip aims. Each trip participant is expected to be self-sufficient on the mountain, have the skills to undertake the trip, know the gear to bring and, participate under their own risk and responsibility.

Our trips are of course also weather/conditions dependent. Where possible we try to have a reserve date in case weather changes things. We do not charge for our trips although everyone pays for their own gear, equipment, transport, fuel, food, and in some cases accommodation. If we stay anywhere other than Taurangi Lodge we'll suggest a preferred option as it's always great if everyone stays at the same place.

Special note for winter trips in snow/ice conditions. These trips are for club members who have completed at least Snow Craft 1 (or equivalent). If you need to hire equipment please do so in advance via TAC Gears Officer (contact details at end of this HiTAC and on our www).

Recent Club Trips

Sat 20 October

Surrey Road Trip - Saturday 20th October

This trip originally was to occur in July but due to unfavourable weather it was postponed. The Labour Weekend forecast looked superb so the emails went out to see who was available. The four of us departed Taurangi at 6:30am and climbed up the tussock slope behind the Lodge; this is always the steepest section of the climb! Crampons were put on at 1750m and we headed up Surrey Road ramp and the upper mountain on frozen snow. The wind being between 30 and 35km/hr from the South West meant it was pretty cold in the crater. After a 10am summit photo we headed back down crater valley and snow valley in softening conditions for a well-deserved lunch at Taurangi. Thanks for a great climb Mohamed, Colleen, & Greg. Leader Glen



Upcoming Club Trips

A huge thanks, as always, is extended to those of our experienced club members who volunteer their time to lead & assist our club trips. We couldn't run our trips with you! 😊

Sat 24 & Sun 25 November 2018 - weekend trip
Fanthams Peak summit & Kapuni Lodge overnighter

With spring well & truly upon us, this is a bit of a pot luck trip! Whilst this trip will definitely include an overnight at Kapuni Lodge on Friday night, the climb route & timing will depend upon conditions at the time e.g. we want to avoid scoria & slash where we can so we may go for a full day Saturday climb, or a sunset at Fanthams and a later dinner at Kapuni Lodge, or perhaps even a Saturday small scramble followed by an early start & Sunday sunrise up Fanthams. So come & live a little, bring your wine, sleeping bag, crampons, ice axe & helmet and let's make the most of the weather & conditions 😊 Open to anyone who has completed Snowcraft 1. Further route details will be confirmed nearer the time.

Please contact Trips Coordinator Sophie Tucker on committee2.tac@outlook.com if you're keen to attend this trip.

Sat 19 January 2019 – day trip

Mt Taranaki Sharks Tooth via Blondies & Surrey

This is a fantastic mid-summer route which picks the route via as much remaining snow as possible, from North Ridge across Snow Valley and up Blondies, Surrey and onto Sharks Tooth. Descent will be via the Chimney, Crater, Lizard with options to avoid scoria by descending Snow Valley snow lines. Making the most of the last snow means an early start (5.45am!) from Tahurangi Lodge, so please be prepared to stay at the Lodge on Friday night. This trip is open to all who have completed Snowcraft 1 and who have previously demonstrated suitable confidence/competence on crampons on soft snow, hard snow, rock, and have good rock scrambling skills & experience, all at varying degrees of exposure.

Please contact Trips Coordinator Sophie Tucker on committee2.tac@outlook.com if you're keen to attend this trip.

Summer & Autumn 2019 club trips

Trips planning for summer & autumn 2019 is now underway woo hoooo! Here are some of the trips we're thinking of. Watch this space for dates & details..... 😊

Froggatt / Castle Rock Climbing Weekend – similar to last year – just come along & enjoy a weekend of campong & climbing!

Taranaki summit via Khybers Pass – a favourite easy summit route for those not yet in the know of this local little secret

Taranaki summit via Carrington Ridge – foiled by weather the last 2 years – we're hoping this year will be 3rd time lucky for this harder summit route!

New Members

We welcome these new members to the Club, and look forward to seeing them on the Mountain.

Shem Plummer

New Plymouth

Christine (Grover) Worsfold

Marton

Michael & Sarah Brewer

New Plymouth

Rebecca Randell & Jayden Strickland

New Plymouth

Veronkia Jirasbova

New Plymouth

Charlotte Littlewood

New Plymouth

Members Trips ...

More Stunning Pictures from Glen Hodges

Sunrise Tuesday 23 October



Club Information

TAHURANGI LODGE

This is the TAC's premier Lodge on Mt Egmont / Taranaki. It sleeps 24, has electric heating and cooking, all cutlery, pots and pans, etc. Just like home. Members can request an eKey by completing the application available from the Club's website.

Overnight fees are \$45 for non-members. Members free. Anyone who stays at Tahurangi Lodge must write in the overnight book upstairs by the fridge;

1. Their surname and initials.
2. Say TAC or non-member.

Bookings by non-members or members taking a group of 5+ people should be made with the Lodge Booking Officer, or by booking online via the Club's website. The lodge subcommittee looks after all maintenance. Contact the Lodge committee if you want to help, have ideas for improvements, or have found something wrong. If you find you can't get into the Lodge because of an eKey failure or you have locked yourself out etc., phone either the Club President, or the Lodge Booking Officer. Contact info on Web page. They may be able to help by supplying the current access code.

<http://www.taranakialpineclub.co.nz/pages/contacts.html>

SUBSCRIPTIONS

Annual subscriptions are set at the Annual General Meeting.

Subscriptions for 2017: FAMILY \$65, ORDINARY (single) \$45, STUDENT (under 18), \$35. The subscription halves for those joining after September 1st. For more info contact the Treasurer.

Enquiries to : treasurer.tac@outlook.com

Members with unpaid subs at end of April are sent an account overdue notice. If still unpaid by 1st June incur a penalty of 20%. Any members with unpaid subs at 1st July are removed from membership.

GEAR HIRE

TAC Equipment Officer:

The following equipment is available for hire by TAC Club Members:

Ice axes, ice hammers, helmets, harness (incl. karabiners, etc.). Each item costs \$5/day or a maximum of \$10/day for 2 or more items per person. Return the gear promptly after use and you only pay for the days you actually used it. Return it late and risk paying for the complete period; your choice. A PLB (Personal Locator Beacon) is also available for hire and great for back country tramping or alpine climbing. We also have (new) 6mm Prussic Cord for sale to club members at \$2 per meter. Contact the Equipment Officer AT LEAST 2 days in advance to ensure availability.

EVENTS PROGRAMME

Club nights, trips, instruction and social events are all important functions of the Club's Activities – they need both support from participants as well as volunteers to lead them. If you have suggestions for club nights contact the Club Captain, or would like to volunteer to lead a trip contact the Trips co-ordinator.

HiTAC— Newsletter

A monthly newsletter emailed out to club members with an email address. Also available via the Clubs website www.taranakialpineclub.co.nz

Any trip reports, events, gear for sale can be sent to the Editor at hitac.tac@outlook.com

CHANGE OF ADDRESS

Must be advised in writing – Send to the Secretary by mail to:
Taranaki Alpine Club, PO Box 356, New Plymouth,
or email secretary.tac@outlook.com

Club Links

- [Club Homepage](#)
- [Lodge & Bookings](#)
- [Club Contacts](#)

Copyright © 2018 Taranaki Alpine Club Inc., All rights reserved.

Want to change how you receive these emails?

You can [update your preferences](#) or [unsubscribe from this list](#)

